

## TCB50 Series Normal Metric Bearing

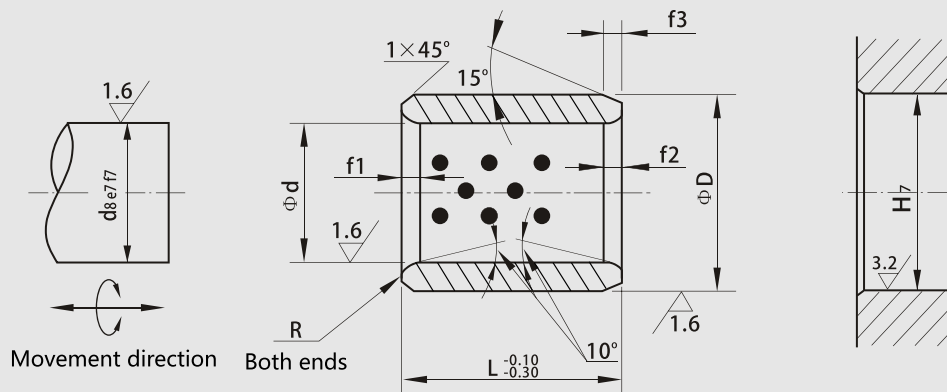

Designation	Shaft Dia.			Housing Bore	L $\begin{smallmatrix} -0.1 \\ -0.3 \end{smallmatrix}$	I.D. $\begin{smallmatrix} \text{Ø } d \\ \text{F7} \end{smallmatrix}$	O.D. $\begin{smallmatrix} \text{Ø } D \\ \text{m6} \end{smallmatrix}$	R	f1	f2	f3
	Heavy Load	Low Load	high-precision								
	d8	e7	f7								
TCB50 □ B 304020	30 $\begin{smallmatrix} -0.065 \\ -0.098 \end{smallmatrix}$	30 $\begin{smallmatrix} -0.040 \\ -0.061 \end{smallmatrix}$	30 $\begin{smallmatrix} -0.020 \\ -0.041 \end{smallmatrix}$	40 $\begin{smallmatrix} +0.025 \\ 0 \end{smallmatrix}$	20	30 $\begin{smallmatrix} +0.041 \\ +0.020 \end{smallmatrix}$	40 $\begin{smallmatrix} +0.025 \\ +0.009 \end{smallmatrix}$	2	3	3	2
TCB50 □ B 304030					30						
TCB50 □ B 304040					40						
TCB50 □ B 304050					50						
TCB50 □ B 304060					60						
TCB50 □ B 405020	40 $\begin{smallmatrix} -0.080 \\ -0.119 \end{smallmatrix}$	40 $\begin{smallmatrix} -0.050 \\ -0.075 \end{smallmatrix}$	40 $\begin{smallmatrix} -0.025 \\ -0.050 \end{smallmatrix}$	50 $\begin{smallmatrix} +0.025 \\ 0 \end{smallmatrix}$	20	40 $\begin{smallmatrix} +0.050 \\ +0.025 \end{smallmatrix}$	50 $\begin{smallmatrix} +0.025 \\ +0.009 \end{smallmatrix}$	2	3	3	2
TCB50 □ B 405030					30						
TCB50 □ B 405040					40						
TCB50 □ B 405050					50						
TCB50 □ B 405060					60						
TCB50 □ B 405070					70						
TCB50 □ B 405080					80						
TCB50 □ B 506030	50 $\begin{smallmatrix} -0.080 \\ -0.119 \end{smallmatrix}$	50 $\begin{smallmatrix} -0.050 \\ -0.075 \end{smallmatrix}$	50 $\begin{smallmatrix} -0.025 \\ -0.050 \end{smallmatrix}$	60 $\begin{smallmatrix} +0.030 \\ 0 \end{smallmatrix}$	30	50 $\begin{smallmatrix} +0.050 \\ +0.025 \end{smallmatrix}$	60 $\begin{smallmatrix} +0.030 \\ +0.011 \end{smallmatrix}$	3	4	4	3
TCB50 □ B 506040					40						
TCB50 □ B 506050					50						
TCB50 □ B 506060					60						
TCB50 □ B 506070					70						
TCB50 □ B 506080					80						
TCB50 □ B 607530	60 $\begin{smallmatrix} -0.100 \\ -0.146 \end{smallmatrix}$	60 $\begin{smallmatrix} -0.060 \\ -0.090 \end{smallmatrix}$	60 $\begin{smallmatrix} -0.030 \\ -0.060 \end{smallmatrix}$	75 $\begin{smallmatrix} +0.030 \\ 0 \end{smallmatrix}$	30	60 $\begin{smallmatrix} +0.060 \\ +0.030 \end{smallmatrix}$	75 $\begin{smallmatrix} +0.030 \\ +0.011 \end{smallmatrix}$	3	4	4	3
TCB50 □ B 607540					40						
TCB50 □ B 607550					50						
TCB50 □ B 607560					60						
TCB50 □ B 607570					70						
TCB50 □ B 607580					80						
TCB50 □ B 6075100					100						
TCB50 □ B 708540	70 $\begin{smallmatrix} -0.100 \\ -0.146 \end{smallmatrix}$	70 $\begin{smallmatrix} -0.060 \\ -0.090 \end{smallmatrix}$	70 $\begin{smallmatrix} -0.030 \\ -0.060 \end{smallmatrix}$	85 $\begin{smallmatrix} +0.035 \\ 0 \end{smallmatrix}$	40	70 $\begin{smallmatrix} +0.060 \\ +0.030 \end{smallmatrix}$	85 $\begin{smallmatrix} +0.035 \\ +0.013 \end{smallmatrix}$	4	5	5	4
TCB50 □ B 708550					50						

## TCB50 Series Normal Metric Bearing

Designation	Shaft Dia.			Housing Bore	L $\begin{smallmatrix} -0.1 \\ -0.3 \end{smallmatrix}$	I.D. $\varnothing d$	O.D. $\varnothing D$	R	f1	f2	f3
	Heavy Load	Low Load	high-precision								
	d8	e7	f7								
TCB50 □ B 708560	70 $\begin{smallmatrix} -0.100 \\ -0.146 \end{smallmatrix}$	70 $\begin{smallmatrix} -0.060 \\ -0.090 \end{smallmatrix}$	70 $\begin{smallmatrix} -0.030 \\ -0.060 \end{smallmatrix}$	85 $\begin{smallmatrix} +0.035 \\ 0 \end{smallmatrix}$	60	70 $\begin{smallmatrix} +0.060 \\ +0.030 \end{smallmatrix}$	85 $\begin{smallmatrix} +0.035 \\ +0.013 \end{smallmatrix}$	4	5	5	4
TCB50 □ B 708570					70						
TCB50 □ B 708580					80						
TCB50 □ B 7085100					100						
TCB50 □ B 709050	70 $\begin{smallmatrix} -0.100 \\ -0.146 \end{smallmatrix}$	70 $\begin{smallmatrix} -0.060 \\ -0.090 \end{smallmatrix}$	70 $\begin{smallmatrix} -0.030 \\ -0.060 \end{smallmatrix}$	90 $\begin{smallmatrix} +0.035 \\ 0 \end{smallmatrix}$	50	70 $\begin{smallmatrix} +0.060 \\ +0.030 \end{smallmatrix}$	90 $\begin{smallmatrix} +0.035 \\ +0.013 \end{smallmatrix}$	4	5	5	4
TCB50 □ B 709060					60						
TCB50 □ B 709070					70						
TCB50 □ B 709080					80						
TCB50 □ B 809650	80 $\begin{smallmatrix} -0.100 \\ -0.146 \end{smallmatrix}$	80 $\begin{smallmatrix} -0.060 \\ -0.090 \end{smallmatrix}$	80 $\begin{smallmatrix} -0.030 \\ -0.060 \end{smallmatrix}$	96 $\begin{smallmatrix} +0.035 \\ 0 \end{smallmatrix}$	50	80 $\begin{smallmatrix} +0.060 \\ +0.030 \end{smallmatrix}$	96 $\begin{smallmatrix} +0.035 \\ +0.013 \end{smallmatrix}$	4	5	5	4
TCB50 □ B 809660					60						
TCB50 □ B 809670					70						
TCB50 □ B 809680					80						
TCB50 □ B 8010050	80 $\begin{smallmatrix} -0.100 \\ -0.146 \end{smallmatrix}$	80 $\begin{smallmatrix} -0.060 \\ -0.090 \end{smallmatrix}$	80 $\begin{smallmatrix} -0.030 \\ -0.060 \end{smallmatrix}$	100 $\begin{smallmatrix} +0.035 \\ 0 \end{smallmatrix}$	50	80 $\begin{smallmatrix} +0.060 \\ +0.030 \end{smallmatrix}$	100 $\begin{smallmatrix} +0.035 \\ +0.013 \end{smallmatrix}$	4	5	5	4
TCB50 □ B 8010060					60						
TCB50 □ B 8010070					70						
TCB50 □ B 8010080					80						
TCB50 □ B 9011050	90 $\begin{smallmatrix} -0.120 \\ -0.174 \end{smallmatrix}$	90 $\begin{smallmatrix} -0.072 \\ -0.107 \end{smallmatrix}$	90 $\begin{smallmatrix} -0.036 \\ -0.071 \end{smallmatrix}$	110 $\begin{smallmatrix} +0.035 \\ 0 \end{smallmatrix}$	50	90 $\begin{smallmatrix} +0.071 \\ +0.036 \end{smallmatrix}$	110 $\begin{smallmatrix} +0.035 \\ +0.013 \end{smallmatrix}$	4	5	5	4
TCB50 □ B 9011060					60						
TCB50 □ B 9011080					80						
TCB50 □ B 10012060					60						
TCB50 □ B 10012080	100 $\begin{smallmatrix} -0.120 \\ -0.174 \end{smallmatrix}$	100 $\begin{smallmatrix} -0.072 \\ -0.107 \end{smallmatrix}$	100 $\begin{smallmatrix} -0.036 \\ -0.071 \end{smallmatrix}$	120 $\begin{smallmatrix} +0.035 \\ 0 \end{smallmatrix}$	80	100 $\begin{smallmatrix} +0.071 \\ +0.036 \end{smallmatrix}$	120 $\begin{smallmatrix} +0.035 \\ +0.013 \end{smallmatrix}$	4	5	5	4
TCB50 □ B 100120100					100						
TCB50 □ B 11013070					70						
TCB50 □ B 11013080	110 $\begin{smallmatrix} -0.120 \\ -0.174 \end{smallmatrix}$	110 $\begin{smallmatrix} -0.072 \\ -0.107 \end{smallmatrix}$	70 $\begin{smallmatrix} -0.036 \\ -0.071 \end{smallmatrix}$	130 $\begin{smallmatrix} +0.040 \\ 0 \end{smallmatrix}$	80	110 $\begin{smallmatrix} +0.071 \\ +0.036 \end{smallmatrix}$	130 $\begin{smallmatrix} +0.040 \\ +0.015 \end{smallmatrix}$	4	5	5	4
TCB50 □ B 110130100					100						
TCB50 □ B 12014080					80						
TCB50 □ B 120140100	120 $\begin{smallmatrix} -0.120 \\ -0.174 \end{smallmatrix}$	120 $\begin{smallmatrix} -0.072 \\ -0.107 \end{smallmatrix}$	120 $\begin{smallmatrix} -0.036 \\ -0.071 \end{smallmatrix}$	140 $\begin{smallmatrix} +0.040 \\ 0 \end{smallmatrix}$	100	120 $\begin{smallmatrix} +0.071 \\ +0.036 \end{smallmatrix}$	140 $\begin{smallmatrix} +0.040 \\ +0.015 \end{smallmatrix}$	5	6	6	5
TCB50 □ B 130150100					100						
TCB50 □ B 130150130					130						
TCB50 □ B 140160100	140 $\begin{smallmatrix} -0.145 \\ -0.208 \end{smallmatrix}$	140 $\begin{smallmatrix} -0.085 \\ -0.125 \end{smallmatrix}$	140 $\begin{smallmatrix} -0.043 \\ -0.083 \end{smallmatrix}$	160 $\begin{smallmatrix} +0.040 \\ 0 \end{smallmatrix}$	100	140 $\begin{smallmatrix} +0.083 \\ +0.043 \end{smallmatrix}$	160 $\begin{smallmatrix} +0.040 \\ +0.015 \end{smallmatrix}$	5	6	6	5
TCB50 □ B 140160140					140						
TCB50 □ B 150170100					100						
TCB50 □ B 150170150	150 $\begin{smallmatrix} -0.145 \\ -0.208 \end{smallmatrix}$	150 $\begin{smallmatrix} -0.085 \\ -0.125 \end{smallmatrix}$	150 $\begin{smallmatrix} -0.043 \\ -0.083 \end{smallmatrix}$	170 $\begin{smallmatrix} +0.040 \\ 0 \end{smallmatrix}$	150	150 $\begin{smallmatrix} +0.083 \\ +0.043 \end{smallmatrix}$	170 $\begin{smallmatrix} +0.040 \\ +0.015 \end{smallmatrix}$	5	6	6	5
TCB50 □ B 160180100					100						
TCB50 □ B 160180150					150						

Label mode

Type      I.D.      O.D.      High  
 TCB50 □ B    160    180    150



K303T No sign  
 F404 Sign B